

RFO基本规格:

- 工作温度: 100deg.C
- 压力: 铜200psi或聚丙烯(PP)100psi
- 显示器: Polysulfone
- 密封圈: 合成橡胶或Viton
- 转子: 尼龙或PPS合成(黑色或橙色)
- 转子轴心: 陶瓷
- 外壳: 铜或聚丙烯(PP)
- 液体粘度: 200SSU

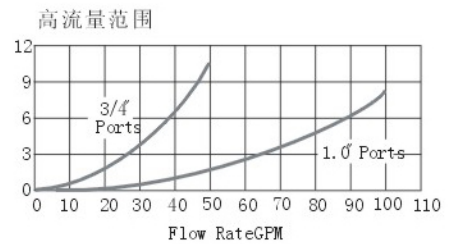

RFO系列 - 只供观察流量情况带脉冲讯号输出

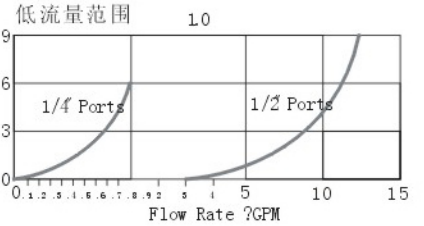
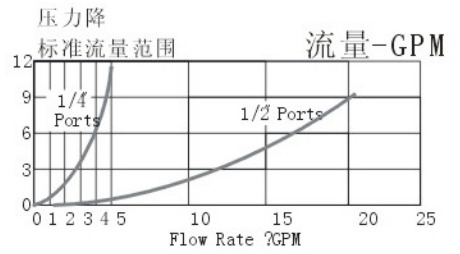

RFO规格:
 精度: +/-5%
 输入: 4.5VDC-24VDC
 输出: 4.5VDC-24VDC Pulse, 70mA
 频率: 25Hz (低流量) 225Hz (高流量)

工作原理

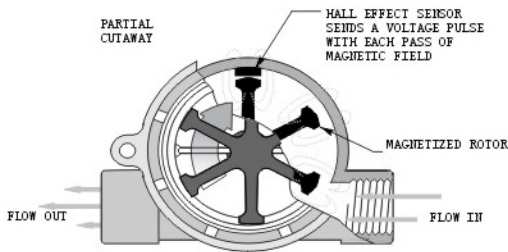

Dimensions

Polypropylene Bodies

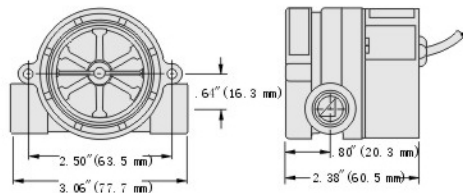

Brass and Stainless Steel Bodies - .25 and .50 Ports

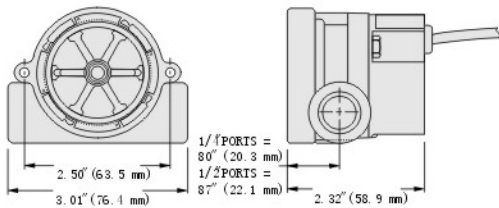

Brass Bodies .75 and 1.00 NPT Ports

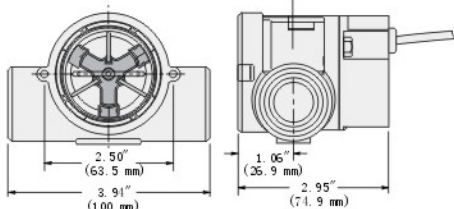

接触材料

转子轴	聚丙烯(PP)铜及不锈钢 Ceramic
转子	Moulded Nylon, Colour, High Visibility Orange qujqPolysulfone
O型密封圈	Buna N
最高工作压力	聚丙烯(PP)外壳7bar 铜及不锈钢外壳14bar
最高工作温度	聚丙烯(PP)外壳 -29 - 82deg.C 铜及不锈钢外壳 -29 - 100deg.C
电子部件	65 deg.C
最高粘度	45 cst
输入电压	4.5 to 24 Vd.c.
输出讯号	4.5 to 24 Vd.c. Pulse, Pulse Rate dependent on Flow Rate, Port Size and Range 0 to 10 V available (RFA model), Consult Sales Office
最大输出电流	70 mA
频率输出	25 Hz (Low Flow) to 225 Hz (high Flow)
电源连接	AWG#2 PVC-Jacketed Cable, Length 60 cm Colour Code: Red=+Vd.c., Black=Ground, White=Signal output

订货号

外壳材质	连接口径	流量范围 (Lpm)		订货号
		低流量	高流量	
PP	1/4"	0.4 to 4.0 (+/-7%)	2.0 to 20.0 (+/-7%)	155421
	1/2"	6.0 to 45.0 (+/-7%)	15.0 to 75.0 (+/-15%)	155481
铜	1/4"	0.4 to 4.0 (+/-7%)	4.0 to 25.0 (+/-7%)	156261
	1/2"	6.0 to 45.0 (+/-7%)	15.0 to 75.0 (+/-15%)	156262
	3/4"	-	7.5 to 112.5 (+/-15%)	194761
	1"	-	15 to 225 (+/-15%)	194762
不锈钢	9/16-18	0.4 to 4 (+/-7%)	4 to 20 (+/-15%)	165071
	1/2"	6 to 45 (+/-7%)	15 to 75 (+/-15%)	165075
	3/4"	-	20 to 120 (+/-15%)	194763
	1"	-	15 to 225 (+/-15%)	194764

